

FLOOR PLANS

FIRST FLOOR

On Fetzer Center's first floor, you will find the Kirsh and Putney auditoriums, banquet and meeting rooms, along with access to our beautiful outside garden patio. Also, on this level, you will find our staff offices located behind the receptionist area.

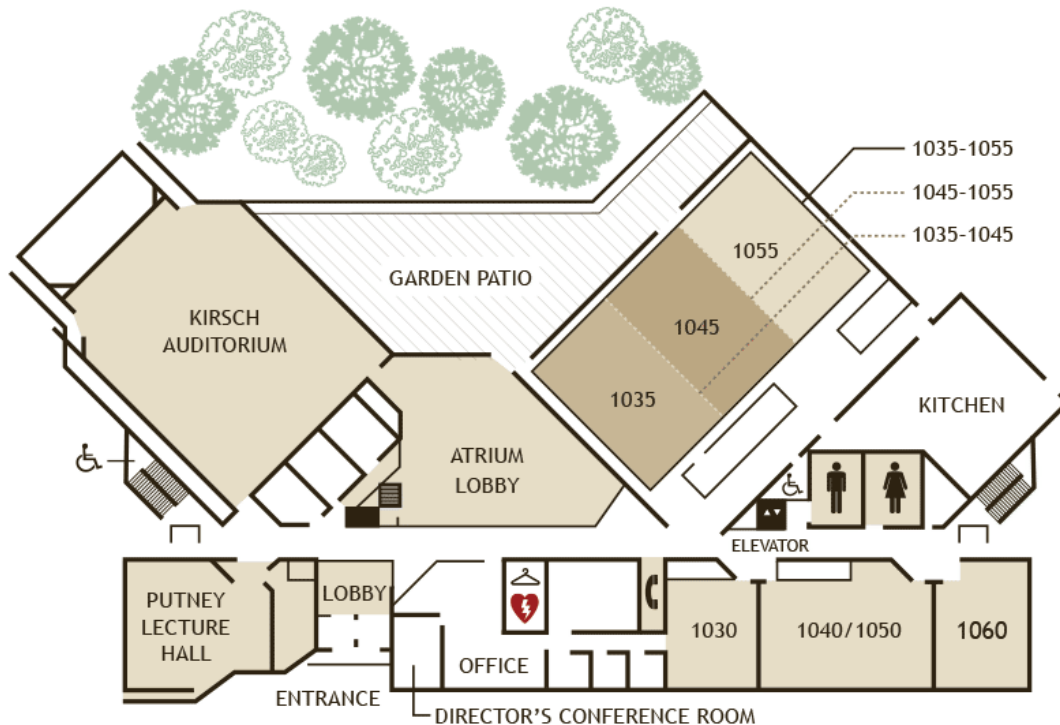

SECOND FLOOR

The Fetzer Center's second floor consists primarily of additional meeting rooms. There is an elevator for easy access to this level.

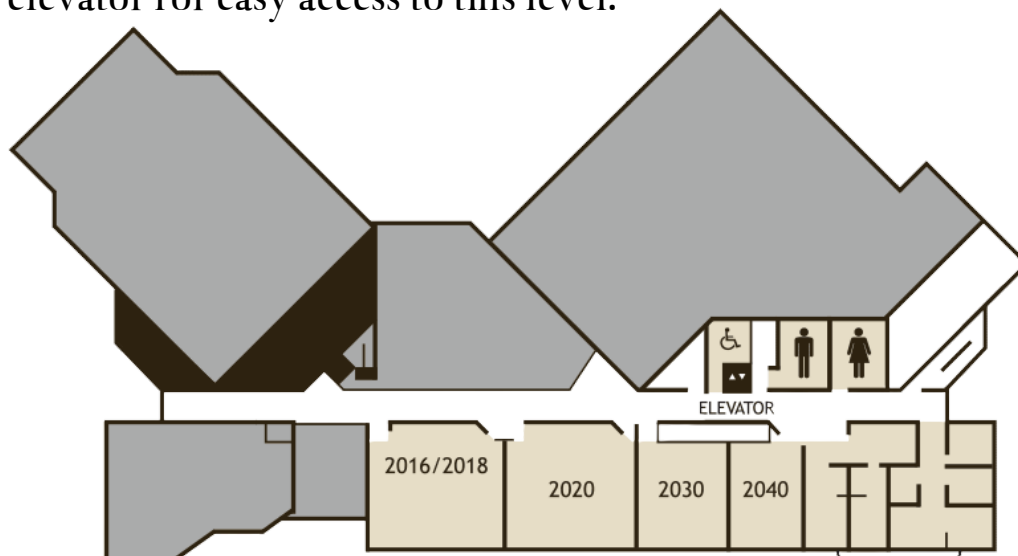

Set-up & Capacity

Fetzer Center's flexible venue allows for several configurations depending on your event needs. Below is a chart that shows the capacity for each of our rooms and the available room set-ups. Also, note that you can choose the room set-up option to view a graphical representation of that set-up.

FIRST FLOOR

ROOM	PRICING	WIDTH	LENGTH	SQ.FT.	CONFIGURATION OPTIONS					MEDIA	
					AUD	CLASS	CONF.	U-SHAPE	ROUNDS	WHITE BOARD	PROJECTOR/ SCREEN
Atrium Lobby	\$175	45'	50'	2,050							
Kirsch Auditorium	\$500	62'	73'	4,426	250					✓	✓
Putney Lecture Hall	\$200	29'	37'	1,073	90					✓	✓
Room 1030	\$175	23'	29'	667			20			Portable	✓
Room 1040/1050	\$200	29'	46'	1,334	90	76	40	32	72	Portable	✓
Room 1060	\$175	23'	29'	667	50	30	24	18	35	Portable	✓
Room 1035	\$250	29'	46'	1,330	100	60			72	Portable	Portable
Room 1045	\$250	29'	46'	1,330	100	60			72	Portable	Portable
Room 1055	\$250	29'	46'	1,330	100	60			72	Portable	Portable
Room 1035–1045	\$500	46'	58'	2,668	250				168	Portable	Portable
Room 1045–1055	\$500	46'	58'	2,668	250				168	Portable	Portable
Room 1035–1055	\$750	46'	88'	4,048	400				280	Portable	Portable

 Automated external defibrillator (AED) located in the coat room near the office.

SECOND FLOOR

ROOM	PRICING	WIDTH	LENGTH	SQ.FT.	CONFIGURATION OPTIONS					MEDIA	
					AUD	CLASS	CONF.	U-SHAPE	ROUNDS	WHITE BOARD	PROJECTOR/ SCREEN
Room 2016/2018	\$200	33'	36'	1,164	80	60	36	28	60	✓	✓
Room 2020	\$200	33'	36'	1,164	80	60	36	28	60	Portable	✓
Room 2030	\$175	24'	33'	782	50	30	28	22		Portable	✓
Room 2040	\$175	24'	33'	782	50	30	28	22		Portable	✓
Room 2050	\$150	Suites								NA	

NOTE: Capacity for wedding rounds depends on the choice of dance floor and banquet options—with both options selected seating capacity is 200 people.

ROOM SETUP OPTIONS

Fetzer Center offers many room setups to meet your event's needs. Our flexible room arrangements make it easy to accommodate the following options:

AUDITORIUM

Auditorium style

Auditorium (or theatre) style seating allows the greatest number of people to fit comfortably into one room. Auditorium seating is designed for lectures and other forms of one-way communication, such as a presentation given from the front of the room.

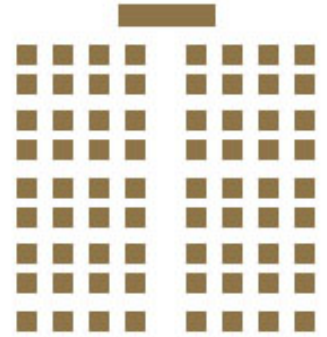

CLASSROOM

Classroom style

In classroom-style seating, rectangular tables are arranged in horizontal rows so that participants are facing the front of the room. Classroom style is used when participants will need to write or refer to handouts during the meeting.

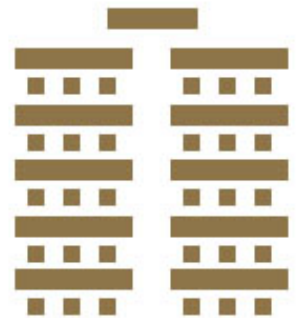

CONFERENCE

Conference style

This closed-square or rectangular seating arrangement is used for meetings where participants are encouraged to interact, problem-solve, and negotiate. Since every person can see each group member, a leader may or may not be necessary.



U-SHAPE

U-shaped, or open-square/rectangle seating, is used to combine a lecture or presentation format with group interaction. This seating structure is often combined with video conferencing.

